

DIN 933
Zeskantbout

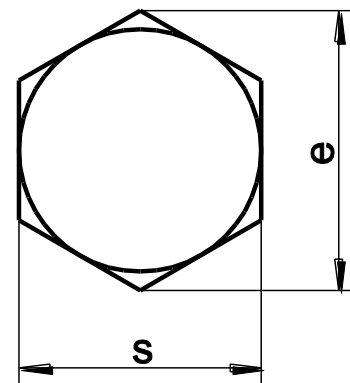
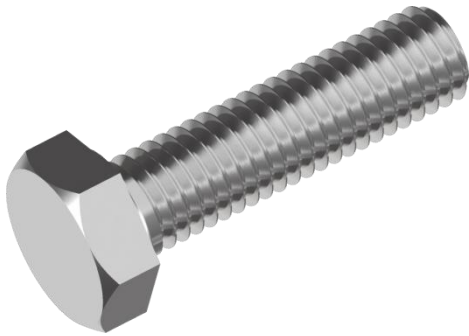

diam	M2	M2.5	M3	M4	M5	M6	M8	M10	M12	M14	M16	M18	M20	M22	M24	M27	M30	M33	M36
k max.	1.4	1.7	2.0	2.8	3.5	4.0	5.3	6.4	7.5	8.8	10.0	11.5	12.5	14.0	15.0	17.0	18.7	21.0	22.5
s	4	5	5.5	7	8	10	13	17	19	22	24	27	30	32	36	41	46	50	55
e	4.32	5.45	6.01	7.66	8.79	11.05	14.38	18.90	21.10	24.49	26.75	30.14	33.53	35.72	39.98	45.20	50.85	55.37	60.79